



TRICEL

GENERATIONS OF INNOVATION

TANKS AND PUMPS.

Product Catalogue

tricelwater.co.uk

We operate across 17 Locations in Europe



Killarney HQ

PUMPS & TANKS

Cavan

Baldonnell

Dublin

PUMPS & TANKS

Newry

Weston

PUMPS & TANKS

Portsmouth

PUMPS & TANKS

Tappernøje

Lanark

PUMPS & TANKS

Leeds

Brierley Hill

Gloucester

Hemel

PUMPS & TANKS

Croydon

PUMPS & TANKS

Dartford

Poitiers

Avignon

TANKS & PUMPS

KEY FEATURES & BENEFITS:



Advanced Manufacturing:

Tricel utilises hot compression moulding for tank production, ensuring high-quality & precise construction.



Durability:

GRP material offers excellent resistance to corrosion, rust, and degradation, ensuring long-term performance even in harsh environments.

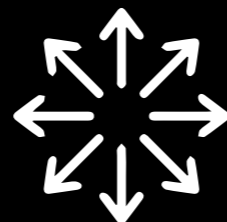

Versatility:

Tricel's tanks are suitable for various applications, including domestic, commercial, and agricultural water storage needs.



Technical Expertise:

Tricel possesses specialised knowledge and advanced facilities for the production of GRP tanks, ensuring superior quality & customisation options.



Tricel, a global leader in water solutions, leverages its expertise in Glass Reinforced Plastic (GRP) to offer innovative water storage tanks. With advanced manufacturing facilities and technical proficiency, Tricel produces tanks using hot compression moulding, ensuring precision and durability. Complementing their water solutions, Tricel Pumps draws upon many years of experience to provide a comprehensive range of pumping solutions. Whether customers seek standard pumps, pre-packaged systems, or customised options, Tricel collaborates with industry-leading manufacturers to deliver efficient solutions tailored to specific needs. Additionally, Tricel offers a wide array of spares, parts, kits, and services, ensuring customers receive comprehensive support for their water and pumping needs.

APPLICATIONS:

- **Domestic Water Storage:** Tricel's GRP tanks provide safe and reliable water storage solutions for households. Suitable for potable/drinking water applications.
- **Commercial and Industrial Use:** Tanks are suitable for commercial and industrial applications, such as hotels, factories, and agricultural facilities, where large-volume water storage is required.
- **Agricultural Water Management:** Tricel's tanks are utilised in agriculture for irrigation, livestock watering, and rainwater harvesting, promoting sustainable water management practices.

OUR PRODUCTS

ONE PIECE TANKS & BESPOKE OPTIONS

STANDARD ONE PIECE TANK RANGE.

One Piece Tanks



Key Features:

- Available from 45 litres up to 16,000 litre capacity types.
- Nationwide next day delivery on selected stock models (subject to availability)
- Long life corrosion free design – virtually ZERO maintenance
- Suitable for internal or external applications
- Full range of connections/ancillary items available
- Close fitted sealed lid
- Technical advice on all water storage projects
- Excellent after-sales-service as standard

Bespoke Options



Key Features:

- Standard manufacturing lead-times apply
- Category 5 Type AB or AA air gaps
- Raised Ballvalve Housing to achieve a greater useable capacity and/or to accommodate an AB air gap
- Division to provide a twin compartment that will allow continuous supply during cleaning & system maintenance periods
- Two piece option to facilitate site movement and/or where access through doorways is restricted
- Non-insulated
- Reinforced base
- 50mm insulation

STANDARD OPTIONS

BESPOKE OPTIONS

Tank Model	External Dimensions (L x W x H)	Internal Dimensions (L x W x H)	Nominal Capacity (Litres)	Reinforced Base (as Standard)	Available as Two Piece Tank	Available with Raised Float Valve	Option for Division
TW45	495 x 370 x 345mm	455 x 330 x 335mm	45	X	X	X	X
TW70	532 x 380 x 537mm	455 x 300 x 455mm	70	X*	X	X	X
TW100	770 x 460 x 490mm	655 x 350 x 450mm	100	X*	X	X	X
TW150	785 x 660 x 490mm	655 x 535 x 450mm	150	X*	X	✓	X
TW180	700 x 575 x 575mm	625 x 490 x 560mm	182	X*	X	X	X
TW225	1200 x 535 x 480mm	1100 x 435 x 465mm	227	X*	X	X	X
TW250	785 x 660 x 775mm	670 x 545 x 735mm	250	X*	X	✓	X
TW315	1240 x 585 x 585mm	1150 x 495 x 575mm	318	X*	X	X	X
TW450	1448 x 737 x 599mm	1310 x 600 x 580mm	454	X*	X	✓	X
TW500	1130 x 755 x 840mm	1020 x 625 x 800mm	500	X*	✓	✓	X
TW560	1290 x 1065 x 615mm	1125 x 895 x 575mm	560	X*	X	✓	X
TW700	1645 x 1035 x 590mm	1485 x 870 x 550mm	700	X*	X	✓	X
TW800	1290 x 1065 x 885mm	1130 x 900 x 845mm	800	X*	✓	✓	X
TW970	1285 x 1000 x 965mm	1175 x 900 x 885mm	970	X*	✓	✓	X
TW1000	1180 x 1180 x 1040mm	1030 x 1030 x 1000mm	1000	X*	✓	✓	X
TW1250	1180 x 1180 x 1290mm	1000 x 1000 x 1250mm	1250	X*	✓	✓	X
TW1350	1800 x 1470 x 790mm	1585 x 1190 x 715mm	1350	X*	X	✓	✓
TW1500	1685 x 1185 x 1040mm	1530 x 1030 x 1000 mm	1500	X*	✓	✓	✓
TW1500H	1180 x 1180 x 1540mm	1030 x 1030 x 1500mm	1500	X*	✓	✓	X
TW2000	2185 x 1185 x 1040mm	2030 x 1030 x 1000mm	2000	X*	✓	✓	✓
TW2250	1680 x 1180 x 1560mm	1500 x 1000 x 1500mm	2250	✓	✓	✓	✓
TW2700	2030 x 1500 x 1290mm	1850 x 1250 x 1220mm	2700	✓	✓	✓	✓
TW3000	2180 x 1180 x 1560mm	2000 x 1000 x 1500mm	3000	✓	✓	✓	✓
TW3230	2870 x 1420 x 1050mm	2670 x 1220 x 990mm	3230	✓	✓	✓	✓

STANDARD ONE PIECE TANK RANGE CONTINUED.

Tank Model	External Dimensions (L x W x H)	Internal Dimensions (L x W x H)	Nominal Capacity (Litres)	Reinforced Base (as Standard)	Available as Two Piece Tank	Available with Raised Float Valve	Option for Division
TW3600	2680 x 1830 x 1010mm	2500 x 1575 x 950mm	3600	✓	✓	✓	✓
TW4000	2200 x 2200 x 1060mm	2000 x 2000 x 1000mm	4000	✓	✓	✓	✓
TW4500	2680 x 1830 x 1260mm	2500 x 1575 x 1200mm	4500	✓	✓	✓	✓
TW6000	2200 x 2200 x 1560mm	2000 x 2000 x 1500mm	6000	✓	✓	✓	✓
TW8000	4200 x 2200 x 1060mm	4000 x 2000 x 1000mm	8000	✓	✓	✓	✓
TW8000H	2200 x 2200 x 2060mm	2000 x 2000 x 2000mm	8000	✓	✓	✓	✓
TW9000	3200 x 2200 x 1560mm	3000 x 2000 x 1500mm	9000	✓	✗	✓	✓
TW12000	3200 x 2200 x 2060mm	3000 x 2000 x 2000mm	12000	✓	✗	✓	✓
TW16000	4200 x 2200 x 2060mm	4000 x 2000 x 2000mm	16000	✓	✗	✓	✓

*(Available as Option)

- Manufactured in accordance with BS EN13280 and BS EN13121, the Water Supply (Water Fittings) Regulations 1999 and Regulation 4 approved for use with wholesome water.
- Our products are manufactured under the ISO 9001:2015 Quality Management System, with specific quality control arrangements being based upon BS4549-1 (reinforced plastic mouldings).
- The raw materials of the GRP shall conform as appropriate to BS 3532, resin systems and BS EN14020, E glass rovings.
- Internal isophthalic gelcoat surface on all tanks which is impervious to water and resistant to bacterial growth.
- All tanks are fitted with a cover to exclude light and prevent the ingress of particles and insects.
- The encapsulated insulation used has an Ozone Depletion Potential of zero and Global Warming Potential of less than five and is HCFC & CFC free.
- Our standard 25mm thick insulation has a thermal conductivity value $f 0.85 \text{ w/m}^2 \text{ Deg C}$.

PUMP & TANK SYNERGY

ELVARO B-RANGE

Efficient water management relies on compatible pumps and tanks. Tricel offers solutions designed to work seamlessly.



Elvaro B Range

The Elvaro B is combined tank and variable speed pump set designed to minimise the space used up by the components of a similar installation where the tank is located alongside the pump set. Variable speed operation of the pumps ensures a longer life of the pipework system due to removal of the water hammer common with fixed speed operated pumps.

Mounting the tank on a steel frame above the pumps not only provides a space saving solution but is also an ideal replacement for an existing installation where larger tank capacity can be obtained in the available space.

ELVARO T-RANGE

Efficient water management relies on compatible pumps and tanks. Tricel offers solutions designed to work seamlessly.



Elvaro T Range

The Elvaro T is combined tank and variable speed pump set designed to minimise the space used up by the components of a similar installation where the tank is located alongside the pump set. Variable speed operation of the pumps ensures a longer life of the pipework system due to removal of the water hammer common with fixed speed operated pumps.

Mounting the tank on a steel frame above the pumps not only provides a space saving solution but is also an ideal replacement for an existing installation where larger tank capacity can be obtained in the available space.

PUMP & TANK SYNERGY

FIRE SPRINKLER TANKS

WITH RECOMMENDED PUMPS

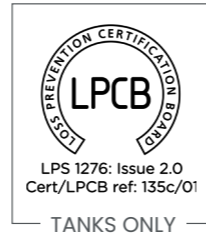

GHVF BOOSTER SET



FIRESAFE



WET RISER SET

SECTIONAL TANKS

WITH RECOMMENDED PUMPS

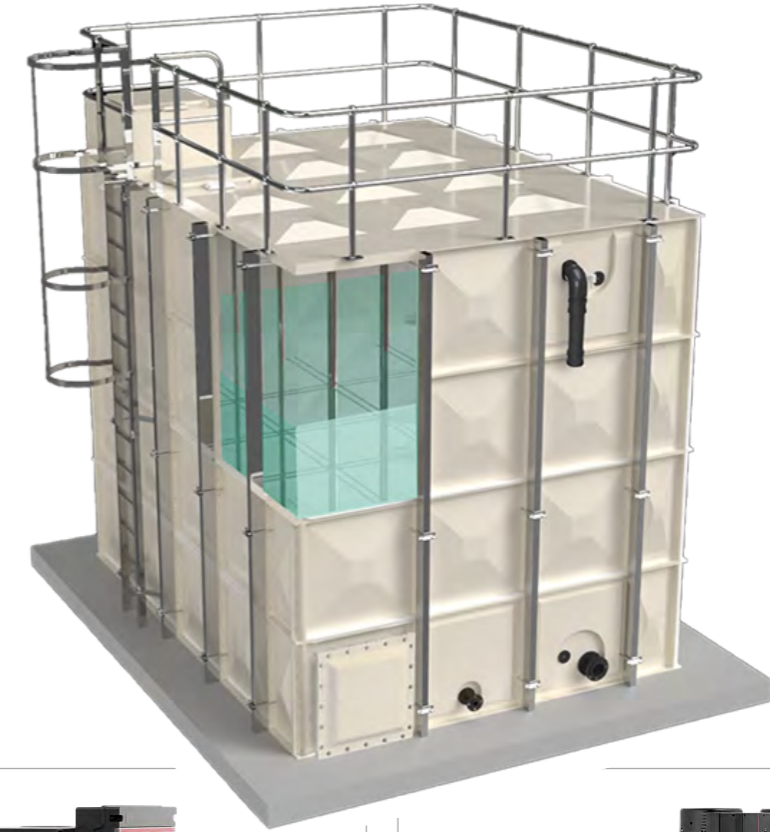

MULTI-E BOOSTER SETS



MPC-E BOOSTER SETS



SMB BOOSTER SETS



GHVX BOOSTER SETS

PUMP & TANK SYNERGY

ONE-PIECE TANKS

WITH RECOMMENDED PUMPS



CRIE SINGLE PUMP



MPC-E BOOSTER SETS



SVE SINGLE PUMP



GHVX BOOSTER SETS

COMBINED TANK & PUMP STATION

WITH RECOMMENDED PUMPS



CME SINGLE PUMP



MULTI-E BOOSTER SETS



HME SINGLE PUMP



SMB BOOSTER SETS

WASTEWATER PUMPING

KEY FEATURES & BENEFITS:



Extensive Product Range

A comprehensive range of pumped and drainage products and services.



Quality Materials

Our award-winning chambers are matched with pumps from the best global manufacturers.



Technical Support

With you from project design and management, through to installation, and lifetime support.



Durability

Our systems are designed to last. Reliability, longevity and ease of service are built in.



Technical Expertise

Recognised industry leaders with a history of innovation and product development.



Customised Solutions

We can tailor your system to perfectly suit your project's requirements.



Part of the Tricel Group of Companies

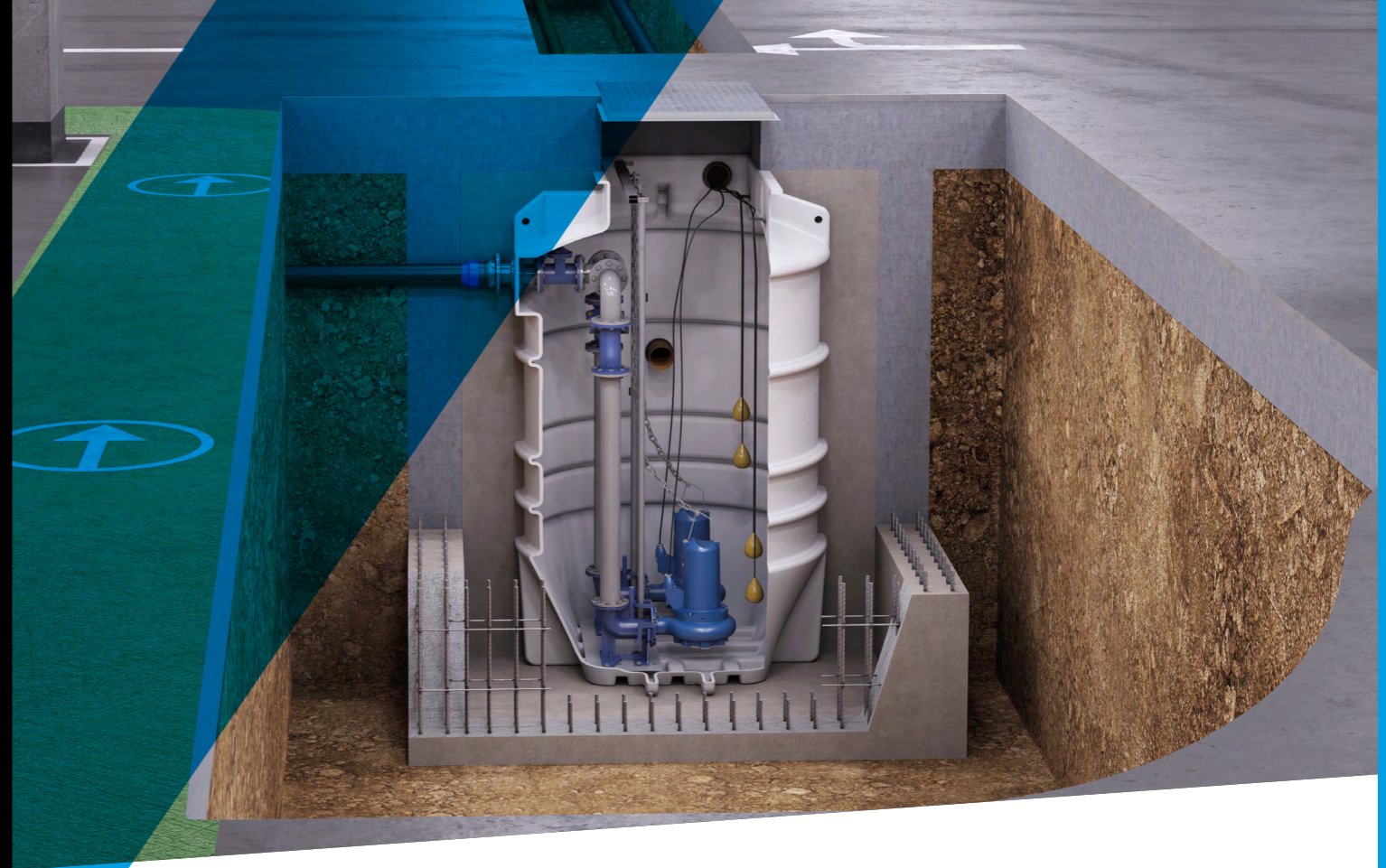

Edincare provides pumped and drainage products and services to the public and private sectors including residential, commercial, hospitality and retail. We are proud of the lasting relationships we have built with clients and partners, delivering cost-effective, robust and dependable products and services.

Research and development, backed up by a wealth of industry knowledge is the cornerstone of our range. Each product has been engineered to deliver optimal performance and reliability.

Key product areas

- Packaged pumping stations
- Waste water pumping systems
- Macerators and macerating toilets
- Floor mounted pumping stations
- Fat, oil and grease separators
- Rainwater harvesting systems
- Battery backup systems
- Adoptable pumping stations
- Submersible pumps
- Accessories

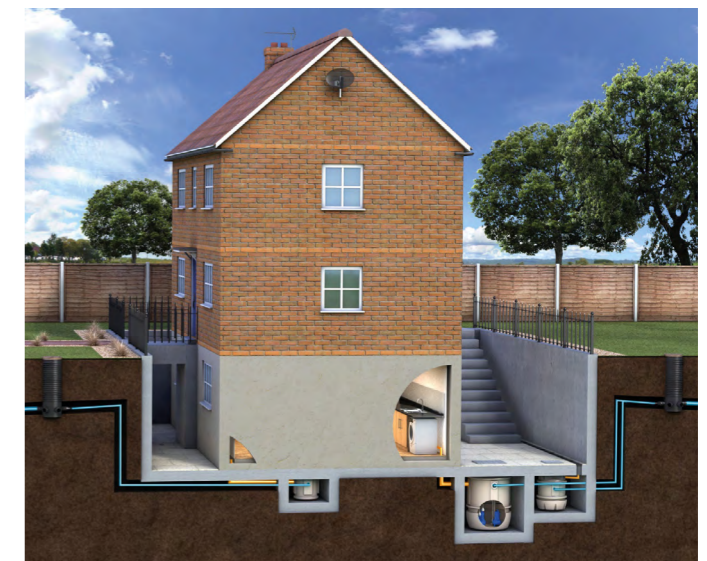

BESPOKE PRODUCTS



Introduction to below ground pumping stations

Call 01442 211 554 or email training@edincare.com to book a free CPD session at your premises today.

Bespoke packaged pumping stations for accepting ground, surface, storm and foul water from whole dwellings or multiple-dwellings.

Our bespoke range of fully automatic packaged pumping stations are suitable for pumping ground, surface, storm and foul water to a higher level when gravity drainage is not possible or economical.

When designing a packaged pumping station we carefully consider every aspect to ensure it perfectly matches your project's individual requirements. This includes reliability, longevity and ease of service. Our systems are designed to excel in their task and are built to last.

They can be installed at construction stage or retrofitted to existing buildings.

Our pumping stations can accept wastewater from extensions, single dwellings, multi-dwelling housing developments, offices, factories, public buildings, hotels, restaurants, schools, car parks, isolated buildings and sewage treatment plants.

Key features

- Suitable for all wastewater types
- Available from stock
- Award-winning chamber design
- 40 sizes up to 2.4 m diameter by 4 m deep
- Wide selection of pumps, level controls and accessories
- Unrivalled quality
- Free no obligation site surveys
- Full project management from tender to handover
- Designed for reliability and ease-of-service

Specification

- BS EN 12050-2:2015 Wastewater lifting plants for buildings and sites. Lifting plants for faecal-free wastewater.
- BS EN 12050-1:2015 Wastewater lifting plants for buildings and sites. Lifting plants for wastewater containing faecal matter.

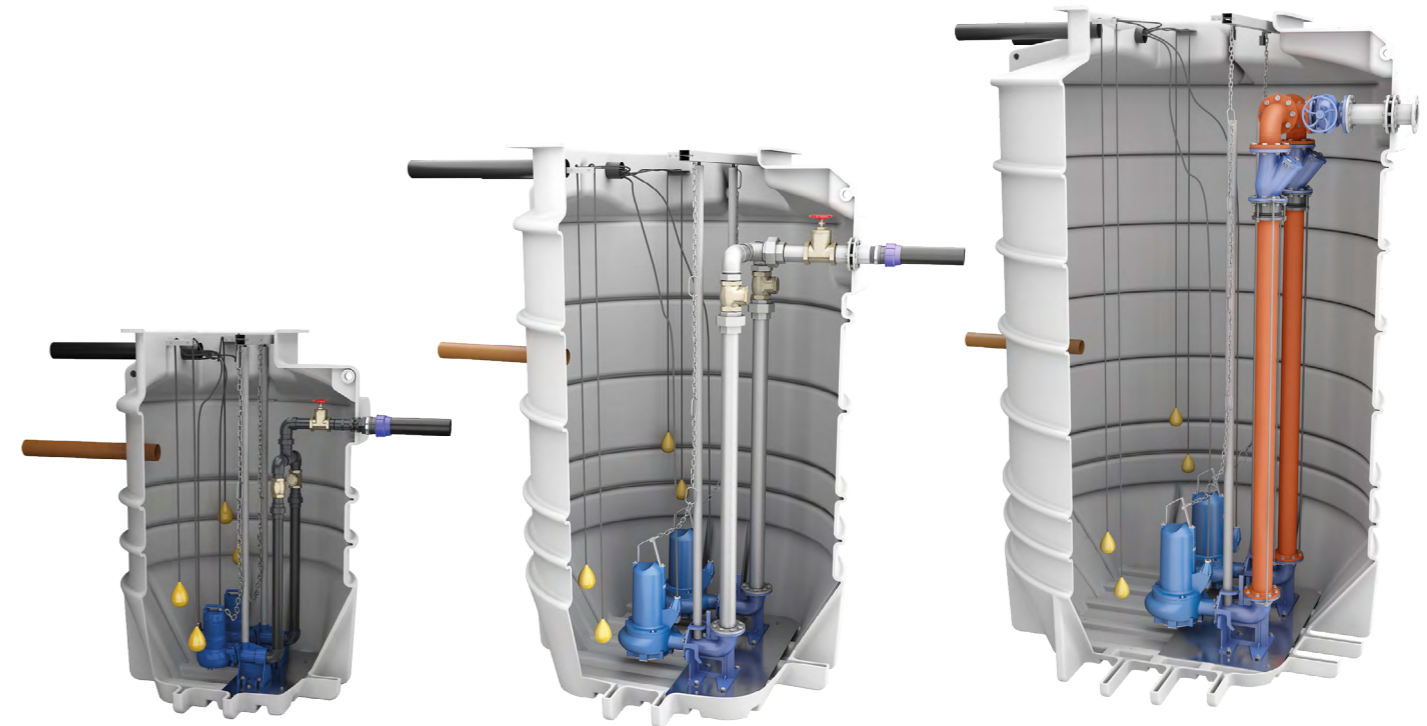

Chamber size options

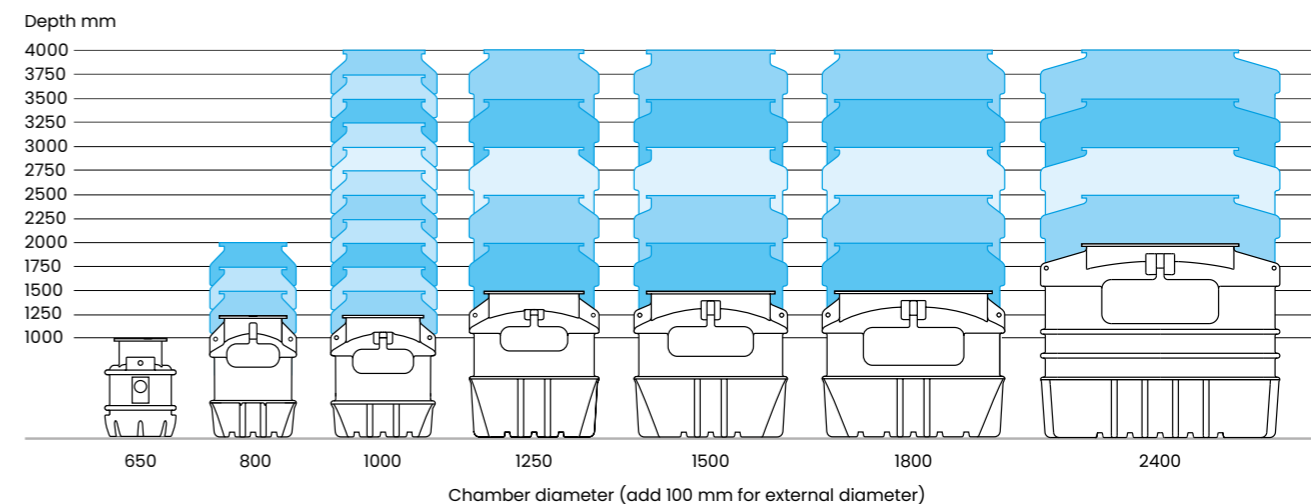

We are proud to work with many leading pump manufacturers, who are recognised for their high quality, long-lasting and robust pumps and associated equipment. We are not limited to a single supplier so will choose the best pump for your project.



Turnkey pumping stations

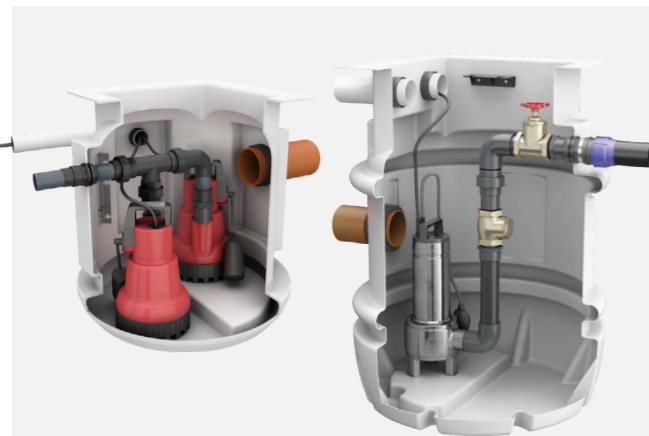

Key Features:

- All wastewater types
- Available from stock
- Very wide range to suit any project
- Customisable
- A choice of alarms and battery backup systems

Fat, oil and grease separators



Key Features:

- Prevent odours and expensive blockages
- Comply with local authority guidelines
- A wide range to suit all commercial kitchens
- Best in class performance and energy efficiency
- Solid waste traps and sediment catchers

Floor mounted pumping stations



Key Features:

- No civils work required
- Single or three phase power
- Single or twin pump options
- Variable inlet positions
- Wide range to suit all applications

Compact grey water systems

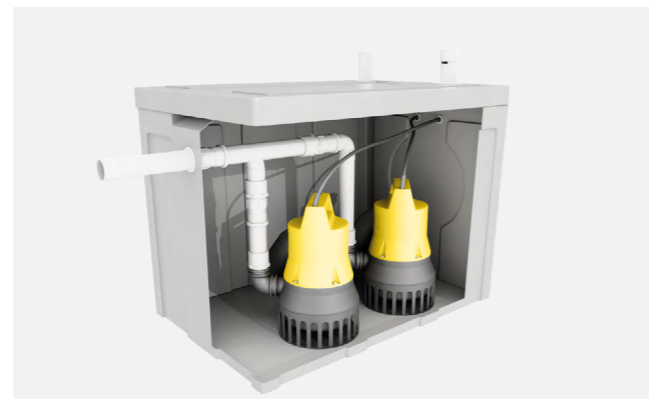

Key Features:

- Ideal for kitchens, utility rooms, tea points and more
- Compact, above ground tanks for easy installation
- High temperature options
- Stainless steel, polyethylene or high temperature GRP
- A choice of alarms and battery backup systems



OUR SERVICES

With an Edincare Service Agreement you will be assigned a dedicated Service Coordinator who will familiarise themselves with your business and look after your assets.

We will provide a Service Call Report after each site visit, ensuring transparency and clear communication at all times. We aim to deliver a 'first time fix', enabled by our experienced engineers and fully-stocked service vehicles.

We provide a 24/7/365 emergency response to all our service customers.



Key services

- Site surveys
- Project management
- Installations
- Commissioning
- Refurbishments
- Emergency call outs
- Planned servicing
- Monitoring
- Tankering
- Drainage CCTV
- Pre- and post-construction surveys
- Drain maintenance
- Cure-in-place repairs
- Excavations

For more information contact us today at:
sales@edincare.com or edincare.com

EDINCARE

Edincare Pumps, Unit 8 Heron Business Park, Eastman Way, Hemel Hempstead, HP2 7FW, United Kingdom

Tel: +44 (0) 1442 211554



TRICEL
GENERATIONS OF INNOVATION

SERVICES

Representatives, technicians, and engineers ready to assist clients in identifying the perfect solution for our requirements. Whether it's recommending the ideal product or offering bespoke services such as on-site delivery, water tank installation, or wastewater treatment plant commissioning, Tricel ensures a seamless experience from start to finish.

Moreover, our commitment extends beyond the point of sale, with a robust post-sales infrastructure in place. We provide ongoing technical assistance, support, and maintenance services to ensure the longevity and optimal performance of our products. Additionally, Tricel stocks a comprehensive inventory of spare parts, ensuring prompt resolution in case of any unforeseen issues, thus guaranteeing customer satisfaction and peace of mind.

Warranty

At Tricel, we understand the importance of peace of mind when it comes to your purchases. That's why we stand behind the quality of our products by offering warranties on select items. Our warranties are a testament to the confidence we have in the durability and performance of our goods. If you're interested in learning more about the specific warranties available or have any inquiries about our products, don't hesitate to reach out to our sales team. They're here to provide you with all the information you need to make informed decisions about your purchases.

Contact

sales@tricel.co.uk

WATER STORAGE SPECIALISTS

TRICEL LANARK

Riverside Road, Kirkfieldbank,
Lanark, ML11 9JS,
United Kingdom.

T: +44 (0) 1934 421 477
E: sales@tricelwater.co.uk

TRICEL WESTON

Winterstoke Road,
Weston-super-Mare,
BS24 9AN, United Kingdom.

T: +44 (0) 1934 421 477
E: sales@tricelwater.co.uk

TRICEL CROYDON

10 Tait Road,
Croydon, CR0 2DP,
United Kingdom

T: +44 (0) 1934 421 477
E: sales@tricelwater.co.uk

PUMPING SOLUTIONS

TRICEL PORTSMOUTH

Unit 14, Arnside Road,
Waterlooville, Hampshire,
PO7 7UP, United Kingdom

T: +44 (0) 239 226 8511
E: sales@tricelpumps.co.uk

For more information contact us today at:

sales@tricelwater.co.uk or tricelwater.co.uk